

PRODUCT DATA

TYPICAL OIL VOLUME: 1100 L

TYPICAL WEIGHT: 3300 KG (EXCL KLYSTRON, MAGNET, OIL)

	Drawn OR Approved RW 2019-08-15	Scale 1 : 20	Date 2019-07-11
	Name K500, Product drawing	Sheet 1 / 2	REVISION 00
Document Number DRW-025275			

3,2
 Other surfaces:
 Tolerance class in accordance with ISO 2768-m
 A2

Printed out: 15.08.2019 15:00:28

ACCESS & SERVICE AREA (1 : 20)

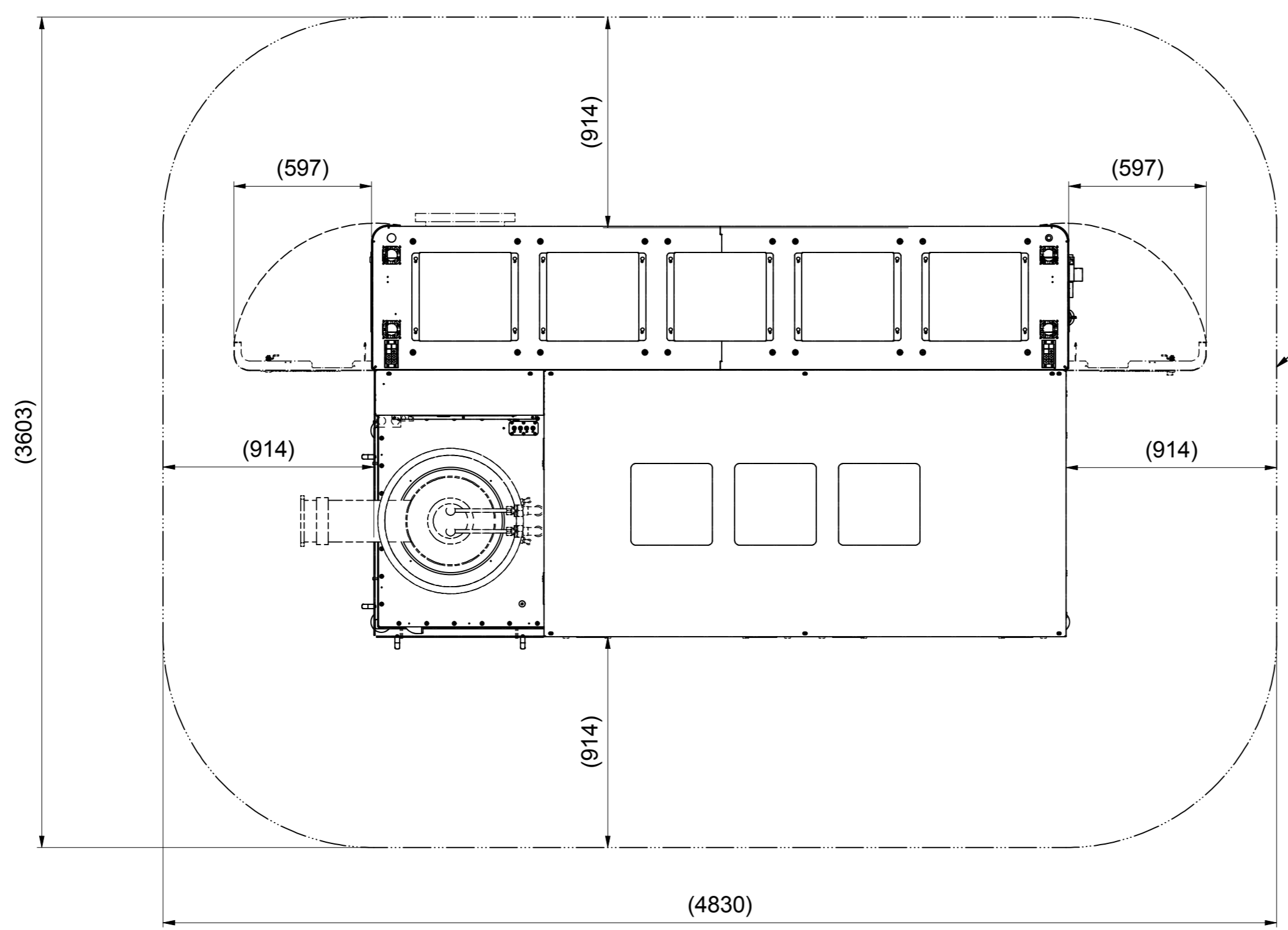
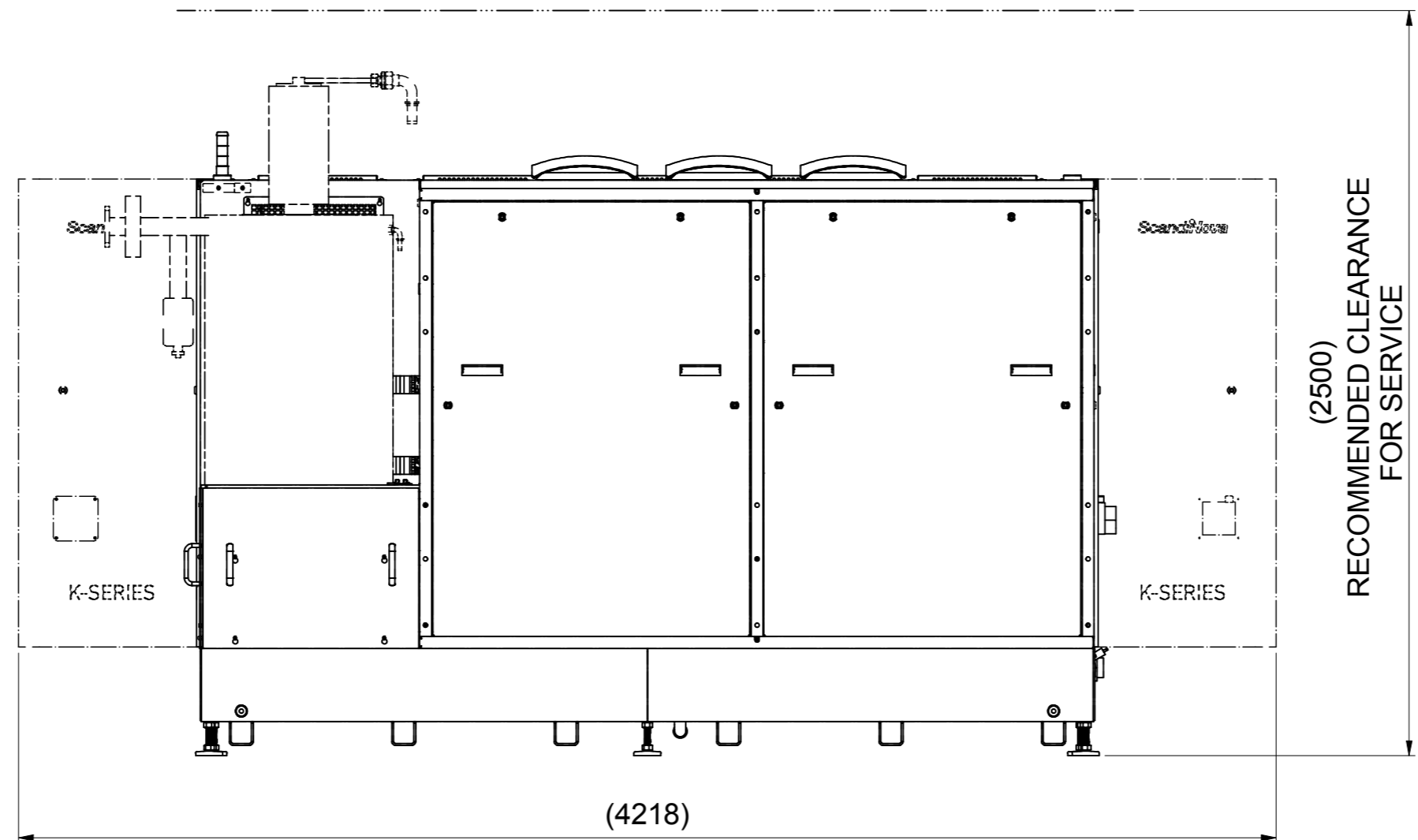

NOTE!
RECOMMENDED CLEARANCE
FOR SERVICE

3.2
Other surfaces:

Tolerance class in accordance with ISO 2768-m
A2

	This document is our property and shall not without our permission in writing be altered, copied, used for manufacturing or communicated to any other person or company.	Drawn OR	Scale 1 : 20	Date 2019-07-11
		Approved RW 2019-08-15	Sheet 2 / 2	REVISION 00
Name ScandiNova K500, Product drawing		Document Number DRW-025275		

Printed out: 15.08.2019 15:00:28